



ORPAZ T-SERIES ADAPTERS
USER MANUAL



CAUTION : This manual contains important information on proper assembly, fit, and replacement of parts. Read and follow the instructions carefully before installing the adapters. Incorrectly installing will harm the gear or may cause minor injury to the user Ensure there is no firearm in the holster when installing, modify, disassemble or remove any part from the Holster.

Orpaz Holster designs vary according to specific firearms. Users have to verify that the holster fits their firearm. Before using the holster make sure your pistol is checked, clear, and safe, with no magazine in the well. Do not use a loaded handgun with any ORPAZ Holster without first testing in the unloaded condition, Do not carry any pistol with a round in the chamber unless you have received professional training. When drawing, testing or adjusting your holster, keep your finger away from the trigger, Be sure your safety is engaged, and keep the gun pointed in a safe direction. Drawing and holstering a firearm can be dangerous with risk of personal injury or death. You must seek proper instruction and training, Always use your firearm as recommended by the manufacturer.



SUB COMPACT PISTOLS EXTENSION

TO BE USED WITH : T40 | T40X

If you're using a subcompact pistol, this extension is necessary to ensure a good fit in your holster.

Loosen the Phillips screw and take out the magnet.

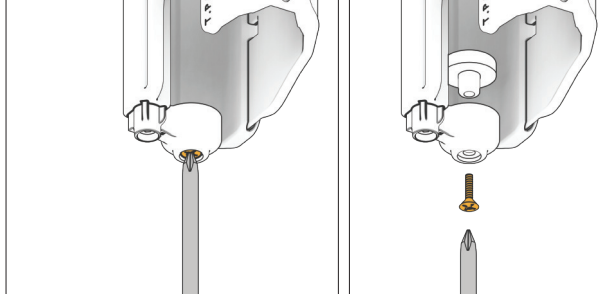

Insert the magnet into the sub compact extension, then connect everything together using the long Phillips screw.

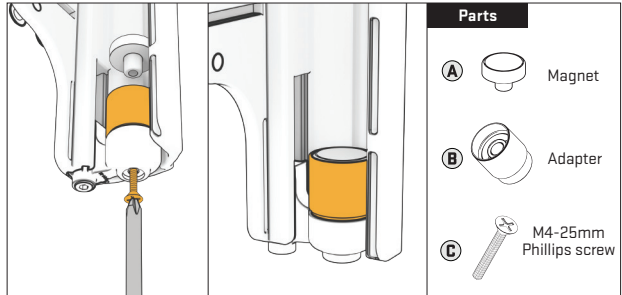

LEG PLATFORM ADAPTER

TO BE USED WITH : T40 | T40X | T41

The adapter is required when mounting a T-series holster on a Leg platform. It makes contact between the components and creates a space between the holster and the Leg platform.

1. Connect the adapter between the holster and the leg platform. Ensure that the position and orientation are correct. (FIG. 1&2)

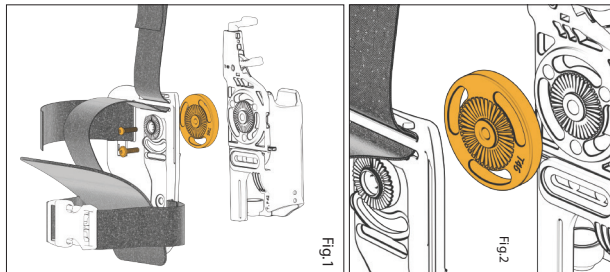

2. Place the screws in the correct order, and tighten both screws firmly. (FIG.3) Do not overtighten.

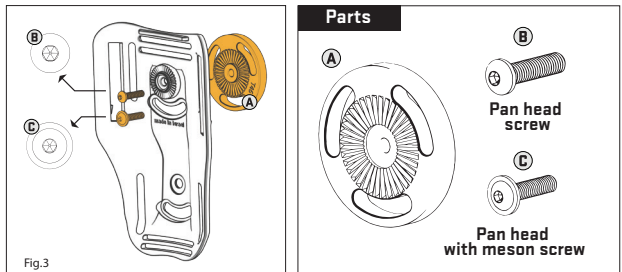

T40X FLASHLIGHT SPACER

TO BE USED WITH : T40X

If you are using a TLR1 / Surefire X300 or a similar dimension flashlight (height less than 1.83 in. (4.64 cm), the attached spacer will keep your flashlight secure and prevent movement in your holster.

1. Take out the screws from the spacer.(A) Make sure the spacer orientation is correct (look for "UP"). (B) Insert the spacer firmly into its place. (C)

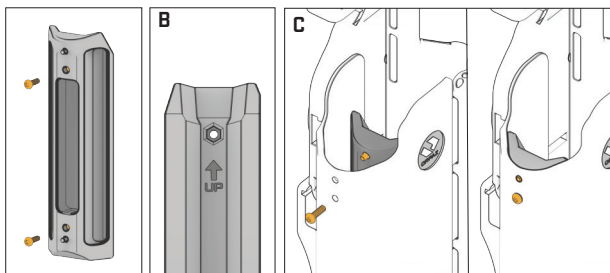

2. Once both pins are in place, and the spacer is stable, firmly hand tighten both screws.

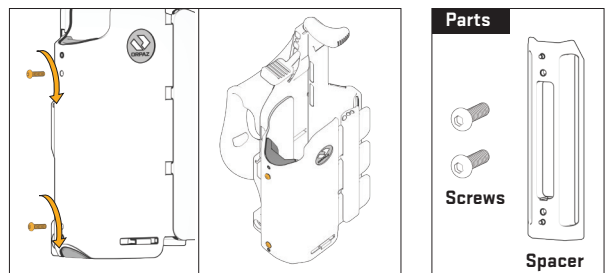

PASSIVE RETENTION MECHANISM REPLACEMENT

TO BE USED WITH : T40 | T40X

The replacement of the Passive retention mechanism enables you to perfectly customize your holster to fit your needs.

(A) Using the Allen key, loosen the bottom hex cap screw. The magnet retention unit will come out.

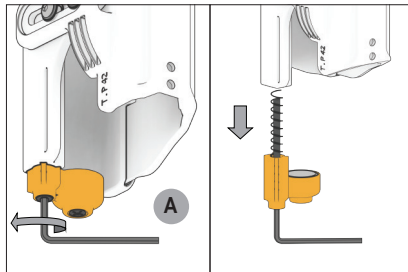

(B) Put the magnet aside, and keep the screw and spring.

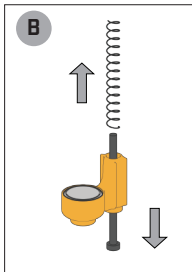

(C) Assemble the screw and the spring respectively onto the new retention adapter.

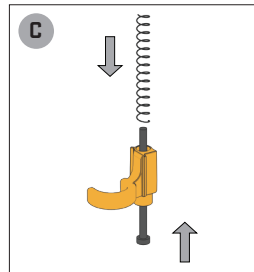

(D) Slide it to the correct position, and tighten it firmly by hand. Adjust the height according to the assembly instructions.

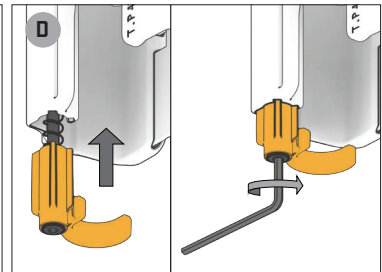

PASSIVE RETENTION TYPES

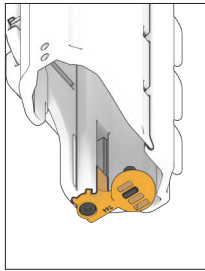

PASSIVE RETENTION ADAPTER

If you wish to remove the magnetic retention, this adapter will keep your pistol secure by using a plug.

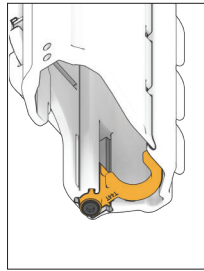
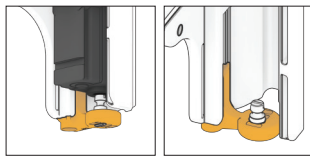

SAFETY ADAPTER

The safety adapter enables you to use your holster while training with a safety Chamber Plug Installed on your pistol.

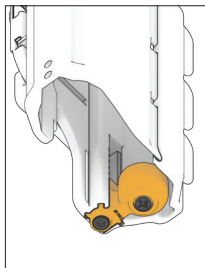
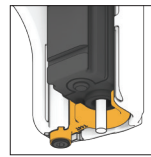

MAGNET RETENTION ADAPTER

The default magnetic retention holds your pistol firmly and provides optimal security in your holster.

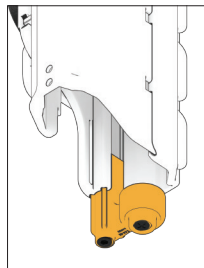
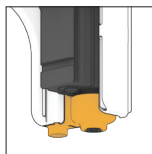

THREADED BARREL EXTENSION

For guns with threaded barrels and pistols with longer slide lengths than 7.5", This extension allows you to carry longer pistols in the holster.

